

REPLACEMENT OF DIAPHRAGM – ELEKTROGAS R/RF regulator

CAUTION:

Shut off the air/gas supply at the main manual shut-off valve before proceeding with servicing.

STEPS FOR DISASSEMBLY:

A-Unscrew the cap (1).

B-Unscrew the setting nut (2).

C-Remove the spring (21).

D-Remove screws of diaphragm cover (19).

E-Remove the safety diaphragm with insert and metallic washer (5, 19, 21).

F-Remove screws of interior cover (9).

G-Remove filter cover (10) with its seal (13) and filter (11).

H-With tongs or similar device, hold the disc at the ribs to keep it still (12 – see picture on right) and unscrew the central nut (3) at the opposite side with its washer (4).

I-Remove disc with its seal (12, 14), main diaphragm (7), diaphragm plate (6) and diaphragm spacer (18).

J-Remove the screws (8) from the compensation plate.

K-Remove the compensation plate (17), compensation diaphragm (16), disc spacer (15).

In the replacement kit you will find:

- 1 x safety diaphragm with insert (5, 21)
- 1 x main diaphragm (7)
- 1 x compensation diaphragm (16)
- 1 x disc seal (14)
- 1 x filter cover seal (13)
- 1 x cap seal (23)

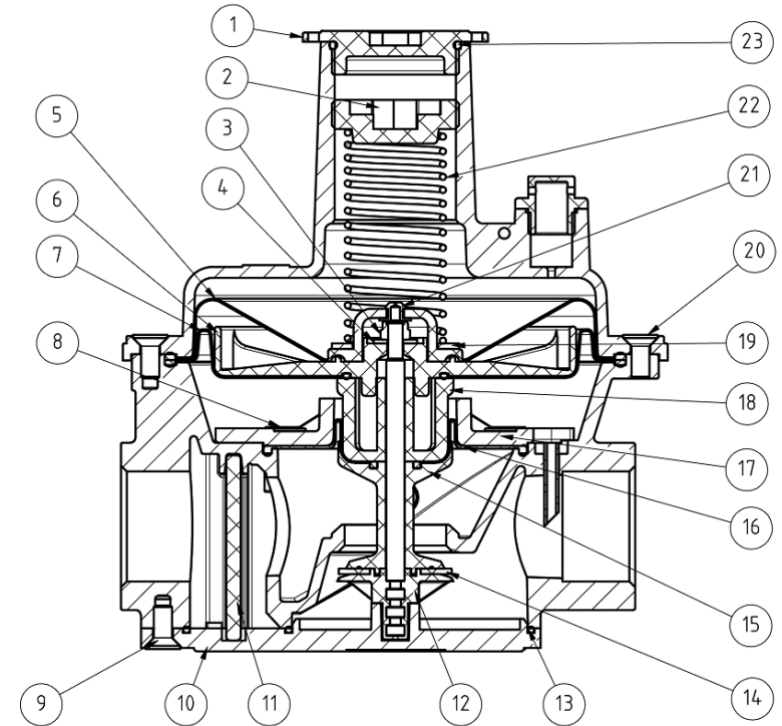

STEPS FOR ASSEMBLY:

A-Put the new seal on the disc, paying attention that it is perfectly centered (see picture on right).

B-Insert the disc with its seal in the body and insert the disc spacer. Pay attention; the disc and spacer have some protrusions which must couple together.

C-Holding the disc, place the new compensation diaphragm and its plate.

D-Maintaining your hold on the disc, fasten the compensation plate with screws.

E-Maintaining your hold on the disc, replace the diaphragm spacer (pay attention; these parts have some protrusions which must couple together), the new main diaphragm and its plate.

F-Maintaining your hold on the disc, replace the small washer and screw the central nut. Use 1.5 Nm torque for size $\frac{3}{4}$ "-1" and 3 Nm for size 1 $\frac{1}{2}$ "-2".

G-Remove the old seal from the filter cover and replace it with the new one. If necessary, use some grease to keep the seal in its seat.

H-Replace the filter (clean it with compressed air if necessary) and then replace the filter cover.

I-Fasten the filter cover with screws.

J-Remove the washer from the old safety diaphragm and place it on the new one.

K-Place the new safety diaphragm over the main plate.

L-Replace the main cover and then fasten it with screws.

M-Insert the spring in the cover, screw the setting nut to a position near to where you found it.

N-Replace the seal of the cap.

When reassembly is complete, perform a leak test prior to use. Set the outlet pressure according to the system requirements.

P-When outlet pressure is correct, install the cap.

