

- // For use with natural gas, propane and air
- // Provides accurate metering of gas flow to industrial gas burners
- // Economical measurements to facilitate proper air/fuel ratio adjustment
- // Available pipe size  $\frac{3}{8}$ " through 2"
- // Custom orifice dimensions
- // Simple installation

## Operating Limits:

Max. Pressure: 7 psi (500 mbar)  
 Type of gas: Natural gas / LPG and air  
 Ambient temperature: -4 to 140 °F (-20 to 60°C)

## Material of construction:

Housing: Die cast aluminium (AlSi12 (Cu))  
 O-Rings: Buna N (NBR)  
 Orifice plate: Aluminium (AlMg3 F24)  
 Test point: included with assembly

## Test Point

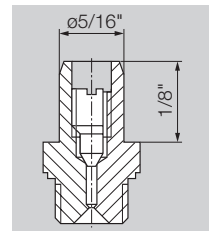

**Mechanical Data:** Flange with NPT-thread

## Air & Natural gas flow capacity (SCFH)

Pipe Size (inch)	Pipe Size (mm)	Model Number	Orifice Size (inch)	Orifice Size (mm)	Natural Gas 3" WC dP	Air 3" WC dP	Order Number
3/8"	10	FLS 110TN05	0.16	4	47	37	85336010
			0.24	6	108	84	
3/8"	10	FLS 110TN05Z	Orifice Size per Customer Request				85336015
1/2"	15	FLS 115TN05	0.16	4	47	37	85336020
			0.24	6	108	84	
1/2"	15	FLS 115TN05Z	Orifice Size per Customer Request				85336025
3/4"	20	FLS 120TN05	0.24	6	107	83	85336030
			0.31	8	192	149	
			0.39	10	305	236	
			0.47	12	453	351	
3/4"	20	FLS 120TN05Z	Orifice Size per Customer Request				85336035
1"	25	FLS 125TN05	0.39	10	300	232	85336040
			0.47	12	437	338	
			0.55	14	605	469	
			0.63	16	813	630	
			0.71	18	1083	839	
			0.79	20	1518	1176	
1"	25	FLS 125TN05Z	Orifice Size per Customer Request				85336045
1 1/4"	32	FLS 232TN05	0.55	14	589	456	85336070
			0.63	16	777	602	
			0.79	20	1257	973	
			0.94	24	1938	1501	
			1.1	28	3273	2536	
			1.26	32	4554	3527	
1 1/4"	32	FLS 232TN05Z	Orifice Size per Customer Request				85336075
1 1/2"	40	FLS 240TN05	0.63	16	768	595	85336050
			0.79	20	1221	946	
			0.94	24	1820	1410	
			1.1	28	2638	2043	
			1.26	32	4144	3210	
1 1/2"	40	FLS 240TN05Z	Orifice Size per Customer Request				85336055
2"	50	FLS 350TN05	1.34	34	3793	2938	85336060
			1.5	38	5177	4010	
			1.65	42	7381	5747	
2"	50	FLS 350TN05Z	Orifice Size per Customer Request				85336065

Capacity based on 60F @ 1 psig up stream pressure / Natural gas specific gravity @ 60 / Air specific gravity @ 1.0

## Warning:

Situations dangerous to personnel and property can result in the misapplication and incorrect operation of combustion equipment. Kromschroder advises compliance with the National Fire Protection Association standards that apply for related equipment and Insurance Underwriters recommendation, and care of operation.

We reserve the right to make technical changes designed to improve our products without prior notice. For current product information, visit our website at [www.kromschroder.com](http://www.kromschroder.com).